

鋁新木[®]

AluCo-Wood

THIRD GENERATION WPC
AluCo Wood
第三代 鋁木複合WPC

Tested accordance to Food
Safety Testing Regulation
for
8 types of Plasticizer
with results
complied to standard

Tested accordance
to SGS Testing and
**formaldehyde
content**
**complied to
standard**

Tested accordance
to SGS Testing and
lead content
**complied to
standard**



通過
食品容器等級
8項塑化劑
檢驗合格
★★★★★

通過
SGS檢測
不含甲醛
★★★★★

通過
SGS檢測
不含鉛
★★★★★

◆Grille Ceilings ◆Wall Panels / Roof Panels ◆Outdoor Decking ◆Railing / Fence ◆Trellis ◆Kiosk, Gazebo, Pergola ◆Conservatory ◆Glass Curtain

■格柵天花 ■牆板/屋頂板 ■戶外地板 ■欄杆/柵欄 ■花架 ■涼亭/廊架 ■陽光房 ■玻璃帷幕

Railing / Fence-P17

欄杆/柵欄

**Conservatory-P21**

陽光房

**Wall Panels / Roof Panels-P13**

牆板/屋頂板

**Kiosk, Gazebo, Pergola-P21**

涼亭/廊架

**Exterior Grille Facades / Ceilings-P09**

外牆格柵/天花



AluCo-Wood

CONTENTS

SGS Testing 01 SGS檢測

Introduction 02 前言

Introduction to AluCo-Wood 03 鋁新木介紹

Product Features 04 產品特性

Product Catalog 05 型材目錄

Grille Series 09 格柵系列

Wall Panel Series 13 牆板系列

Decking Series 15 地板系列

Railing Series 17 欄杆系列

Trellis Series 19 花架系列

Kiosk, Gazebo, Pergola, Glass Curtain, Conservatory 21 涼亭廊架系列、玻璃帷幕、陽光房

Comprehensive Application 23 綜合應用

Staircase Step Panel-P23

樓梯踏板

**Lamppost-P23**

燈柱

**Trellis-P19**

花架

**Outdoor Furnitures-P23**

戶外家具

**Outdoor Decking-P15**

戶外地板

**Main Door, Gate -P23**

戶外大門

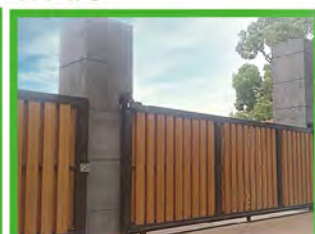

- 1.The drawings provided in this manual are for reference only! If you have any queries on design and installation, you are welcome to contact our company and business unit.
- 2.This series of products (Environmental friendly wood composite) retain high portion of wood context, as such it resemble the appearance and aesthetics of natural wood texture and color.
- 3.Disclaimer
 - (1)Used and Installed in region where temperature should be less than 65 degrees Celsius
 - (2)Damages caused by human negligence such as scratches, fire, stain etc
 - (3)Natural disasters such as ice hail, storm, thunder & lightning etc.
 - (4)Damages caused by improper handling during transportation and onsite storage on uneven ground
 - (5)Damages caused by improper installation or failure to follow the installation instructions supplied with the Products

- 1.本手冊所提供之設計圖，僅供參考！有任何設計、工法安裝的疑問歡迎與本公司單位業務聯繫。
- 2.本系列產品（環保木材）因保留較高木分子，因此容許與實木相近之紋理色差。
- 3.免責條款：(1)安裝於使用區域溫度應低於65度 (2)人為損壞現象，如刮痕、烘烤、塗汗...等 (3)自然災害，如冰雹、暴風、雷擊等。(4)因運輸過程、裝卸不當或現場存放高低不均造成損害(5)因安裝工法不當造成之損害

FiRST Choice

Wood Plastic Composite WPC



SGS TESTING DATA 檢測數據

WPC Testing 塑木檢測

Formaldehyde(Mg/L) 甲醛/CNS15730 : not detected 未檢出
Lead content(mg/kg)鉛含量: not detected 未檢出
Eight plasticizer content 八項塑化劑含量(%): not detected 未檢出
Acid resistance test 耐酸性/CNS 10757(1995) : Surface no influence 表面無影響
Alkali resistance test耐鹼性/CNS 10757(1995) : Surface no influence 表面無影響
Flame Retardant Performance防焰測試/CNS 7614(1994)A法 : Flame Rated 防焰等級
Weather test UV exposure 600h 耐紫外線性試驗: 外觀/無龜裂及粉化現象; 色差(E)≤2
No crack and chalking on exterior of product ; colour difference
Salt Spray Test鹽霧測試/CNS 8886(2002) : No surface corrosion phenomenon
表面無腐蝕現象產生

The above testing data are subjected to change without notice, the latest testing data should prevail!
以上檢測數據如有異動，恕不另行通知，請依最新資訊為準!

AluCo Wood Series Bending failure load (kgf) CNS2215(2012)

鋁新木系列彎曲破壞載重

Model	Test Results測試結果
M6040	> 300 kgf
H6080	Vertical立放 > 500 kgf ; Horizontal橫放 > 1000 kgf
S6080	Vertical立放 > 500 kgf ; Horizontal 橫放 > 1400 kgf
M40100	> 600 kgf
H40200	> 1100 kgf
M12050	Face up正面向上 > 500 kgf ; Face down正面向下 > 800 kgf
S120100	Face up正面向上 > 2300 kgf ; Side up側面向下 > 2100 kgf
M12060	> 600 kgf
S120120	> 2400 kgf
S60100	> 1000 kgf

INTRODUCTION

For the past 20 years, the history for development of wood composite materials had been evolving around the discussion in the properties and relationship of two types of materials - wood & polymers and how to create a new and durable material to substitute them. But there is little break through to solve some of the problems found in thermoplastics. The continuous usage of wood composites in these unstable conditions had limited the continuous development in applications.

There are many different wood composite brands and materials available in the market. E-Core Wood, with its unique woods like surfaces and does not look like plastics, has been an outstanding alternative to wood. But although relatively easy to use, its application is still not comparable to the versatility of wood and wood application in the building and construction industries. Product stability and ease of installation

are main issues with the users. This generation of products are term with skin but no structure.

Due to insufficient strength and product deformation problems, many different wood composite brands add high-strength structural materials such as iron, steel, aluminium and wood through the hollow cavity of wood composite materials. While addressing the issue of structural strength in the wood composite, because wood and metal are handled by different trade specialist and different types of construction interface, tools may be required to use. To complete the project, the duration, labour and hardware may vary greatly and result in the increase in cost.

二十多年來塑木(WPC)的發展歷史，一直在討論兩種材性(木材+塑料)之間的關係，藉以創造一種全新的原物料來取代純木或純塑。但一直無法突破塑化產品的熱塑問題，使得WPC材料處於一種不穩定的使用狀況，而退縮了WPC的應用發展。

當眾多塑木品牌出現在市場上，沂可木 E-Core Wood 努力擺脫塑膠產品的形象與質感而脫穎而出，但在戶外應用實例卻比不上木材的多變性及施工的便利性尤其是結構問題。產品穩定性、安裝施工便利性困擾著使用者，我們形容為有皮無骨的建材。為解決結構性不足，變形等問題，眾多塑木品牌利用WPC中空腔體特性，在結構樑柱等中空位置加入高強結構性的材質，如鋼鐵鋁木等。雖然解決了WPC的結構強度問題，因為施工界面不同需跨不同工種及工具，來完成一工程，因此產生時間、人工、五金...等成本增加。

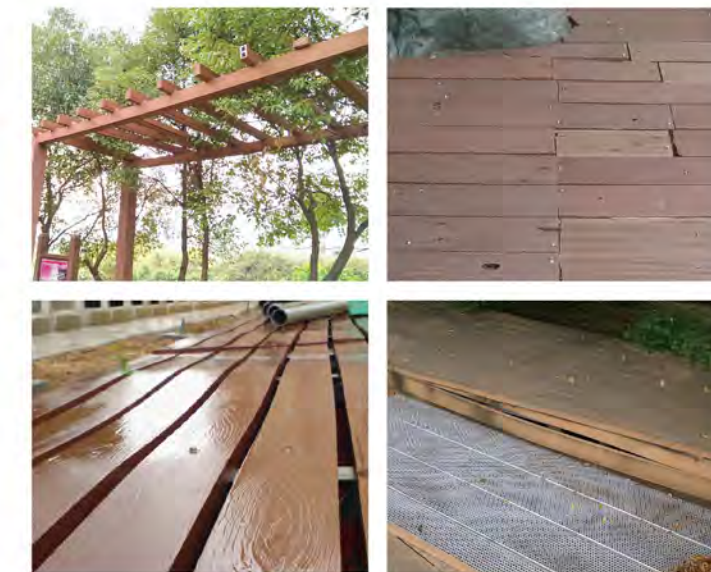

Installation defects from other brands of WPC
他牌塑木安裝案例



鋁新木

AluCo-Wood 誕生



Aluminium is a light and low density material. Aluminium and wood composite materials both use extrusion to form the industrial products. Although both are very different materials with very different characteristics, when apply

together, these very different characteristics will form a new material – ‘AluCo Wood’ with complementary characteristics. ‘AluCoWood’ can be used similar to wood composites but its applications are very much wider because the tools and accessories required for installation are common cross the board. This addresses the past which using different materials, methodology (metal + wood) and their cost increased problems. Because the aluminium and wood composite in ‘AluCo Wood’ are embedded together, the finishes after installation not only provide a very good surface effect and at the same time, the material addresses the past wood composite unstable issues. These highly efficient and stable products significantly reduce in costs.

Based on our original system concept ideas - For future development, the design for other systems will centre around this original concept, retaining the texture and visual of wood in the wood composite and embedding with aluminum profiles. The customers could use the standard products and design new system base on the individual requirement in terms of dimension, size, shape and installation such as sun shade, wall decoration, ceiling, pergola, furniture... etc and any products which are made of wood. This new technological building material concept will replace wood and look like wood.



同為擠出成型的工業化產品，主要讓兩種不同特性的材質可以互補所需，更可以互相緊密結合成為一種新型材料，而鋁是輕金屬、質輕密度低，鋁木複合後在安裝施工上的應用與塑木安裝差異性低，工具要求類似不跨工種施工，解決過去同一工程需不同工種(鐵工+木工)完成的工資成本增加問題。由於採用嵌合式安裝，施工後完成面效果佳同時解決結構安裝、穩定性等WPC本質上的問題，更能大幅降低成本，是一全新型態高效能產品。

本系統原創理念的中心思考為-保留木材質感與觸感的前提下將鋁新木系統型材成為木材或鋁材一樣的原材料，使用者可以依需求選擇標準尺寸規格的鋁木原材料做設計或施工成各種產品，如:遮陽格柵、牆面、天花造型、欄杆、花架、傢俱....等所有木材可做成的產品。成為實質取代木或成為木的新科技建材。

AluCo Wood Feature

鋁新木特點



Vibrant beauty

- ◆ Unique wood grain texture, appearance resembles the beauty and aesthetic of natural wood
- ◆ Weathering changes of color resemble closely to natural wood
- ◆ Conceal hardware accessories, provide aesthetic visual effects
- ◆ Solve the unnatural appearance of traditional aluminum stained and powder-coated wood colour paint surfaces
- ◆ Large range of product categories, unlimited in design



Environmental Safety

- ◆ Water resistance, corrosion resistance
- ◆ Fire and flame retardant properties
- ◆ Resistance to acid & alkali (suitable for application in spa, swimming pool, bathroom)
- ◆ Superior weatherability, do not deteriorate, crack or brittle
- ◆ Tested accordance to SGS testing with formaldehyde and lead contents complied to standard and tested accordance to Food Safety Testing Regulation for 8 types of Plasticizers with results complied to standard



Smart Energy Saving

- ◆ Promote energy-saving effect with thermal insulation and heat preservation properties of aluminum profiles (lower thermal conductivity)
- ◆ Stable quality, long service life, reduce wastage of resources
- ◆ Sun shade grilles series satisfy window opening, ventilation, sufficient level of sun lighting, allowing high wind pressure reduction and shading effect, enhance energy-saving
- ◆ Decking series effectively absorb ultraviolet light & radiant heat, reducing discomfort from reflection of sunlight



Easy Installation

- ◆ Clip-on structure make installation simple, fast
- ◆ Can nail, plane, saw ... easy to install, reduce installation costs, economical and affordable
- ◆ Low maintenance costs

美觀激升

- ◆獨特的木質美感與紋路觸感。
- ◆顏色有著接近自然木色的細緻變化。
- ◆隱藏五金配件，視覺美化效果。
- ◆解決傳統鋁烤木紋漆的不自然感。
- ◆產品種類多元，設計無限。

環保安全

- ◆防水、防腐、防白蟻。
- ◆防焰、具阻燃特性。
- ◆耐酸鹼(適用於溫泉飯店、游泳池畔、浴室)。
- ◆具有優良的耐候性、不變質、不開裂、不脆化。
- ◆通過SGS檢測不含甲醛、鉛並通過食品容器級8項塑化劑檢驗合格。

聰明節能

- ◆提昇鋁合金型材的隔熱，保溫節能功效（降低熱傳導率）。
- ◆品質穩定，使用年限長，減少資源浪費。
- ◆格柵系列同時滿足開窗、通風、高採光並減少風壓與遮陽節 能的效果。
- ◆地板系列有效吸收紫外線、輻射熱、減少陽光反射的不適感。

施工簡易

- ◆拍合式結構安裝施工簡易、迅速。
- ◆可釘、可刨、可鋸...安裝簡易，降低施工成本，經濟實惠。
- ◆低維護費用。

AluCo Wood Product Catalog

鋁新木產品目錄



Specialize hardware accessories

For information, please contact our sales staff !

專業五金配件 請洽業務人員!

Range of application : Exterior Sunshade, Small Columns, Small Beams, Railing, etc
適用範圍：外遮陽、小柱、小樑、欄杆等..

Range of application : Grille, Decorative Trim Moldings, Ceiling Moldings, etc...
適用範圍：格柵、造型飾板、造型天花等..



Side cover/邊蓋
CM6040

Product Name : M6040

Dimension : 60mm * 40mm
Length : 300cm
WPC decorative articles 6040*1
Aluminum base M60*1
尺寸：60mm * 40mm
長度：300cm、360cm
(格柵裝飾條6040*1+鋁M60*1)



鋁基座
Aluminum base
M60

鋁基座
Aluminum base
H60

鋁基座
Aluminum base
S60

Product Name : S6080

Dimension : 60mm * 80mm
Length : 300cm
WPC decorative articles 6040*2
Aluminum base S60*1
尺寸：60mm * 80mm
長度：300cm、360cm
(格柵裝飾條6040*2+鋁S60*1)



Side cover/邊蓋
COH6080
Edge cover/修飾邊框
CT6080

Product Name : H6080

Dimension : 60mm * 80mm
Length : 300cm
WPC decorative articles 6040*2
Aluminum base H60*1
尺寸：60mm * 80mm
長度：300cm、360cm
(格柵裝飾條6040*2+鋁H60*1)

Range of application : Large Sunshade System, Wall Cladding, Railing, etc
適用範圍：大型遮陽系統、造型牆、欄杆等..

Product Name : M12060

Dimension : 120mm * 50mm
Length : 300cm
WPC decorative articles 12050*1
Aluminum base M120*1
尺寸：120mm * 60mm
長度：300cm、360cm
(格柵裝飾條12060*1+鋁M120*1)

鋁基座
Aluminum base
M120



Product Name : M12050

Dimension : 120mm * 50mm
Length : 300cm
WPC decorative articles 12050*1
Aluminum base M120*1
尺寸：120mm * 50mm
長度：300cm、360cm
(格柵裝飾條12050*1+鋁M120*1)



Side cover/邊蓋
CM12050

Range of application : Big Column, Supporting Beams ,Beams etc
適用範圍：大柱、支撐樑、拉樑等..

Product Name : ST120100

Dimension : 120mm * 100mm
Length : 300cm
WPC decorative articles 12050*2
Aluminum base ST120*1
尺寸：120mm * 100mm
長度：300cm、360cm
(格柵裝飾條12050*2+鋁ST120*1)

鋁基座
Aluminum base
ST120

鋁基座
Aluminum base
S120

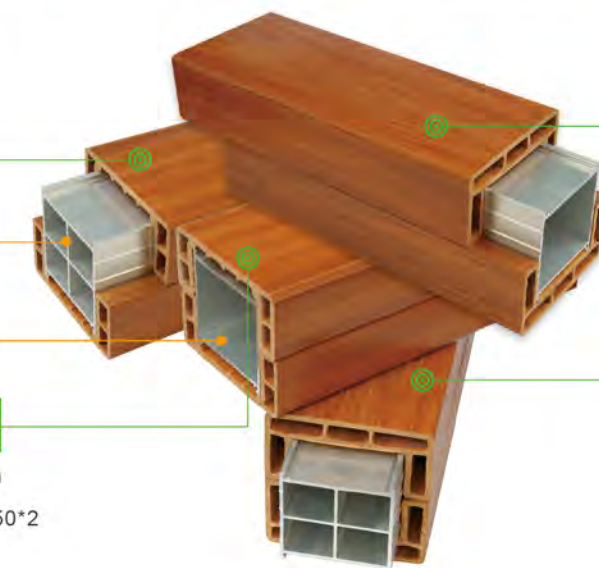

Product Name : S120100

Dimension : 120mm * 100mm
Length : 300cm
WPC decorative articles 12050*2
Aluminum base S120*1
尺寸：120mm * 100mm
長度：300cm
(格柵裝飾條12050*2+鋁S120*1)

Product Name : S120120

Dimension : 120mm * 120mm
Length : 300cm
WPC decorative articles 12060*2
Aluminum base S120*1
尺寸：120mm * 120mm
長度：300cm、360cm
(格柵裝飾條12060*2+鋁S120*1)

Product Name : ST120120

Dimension : 120mm * 120mm
Length : 300cm
WPC decorative articles 12060*2
Aluminum base S120*1
尺寸：120mm * 120mm
長度：300cm、360cm
(格柵裝飾條12060*2+鋁ST120*1)



Column cap/柱頭
COH120120

Range of application : Exterior Sunshade, Wall Cladding, Ceiling, Beams etc
適用範圍：外遮陽、造型牆、天花、拉樑等..



Product Name : M40100

Dimension : 40mm * 100mm
Length : 300cm
WPC decorative articles 40100*1
Aluminum base M40*1
尺寸：40mm * 100mm
長度：300cm
(格柵裝飾條40100*1+鋁M40*1)

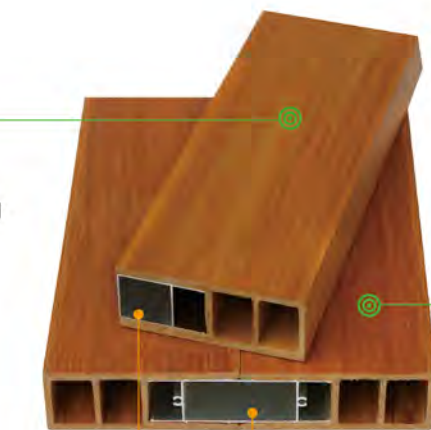

鋁基座
Aluminum base
M40

鋁基座
Aluminum base
H40

Range of application : Large Sunshade, Beam Column, Tables, Chairs and Board Surface etc
適用範圍：大型遮陽系統、間隔樑柱、桌椅板面等...

Product Name : H40200

Dimension : 40mm * 200mm
Length : 300cm
WPC decorative articles 40100*2
Aluminum base H40*1
尺寸：40mm * 200mm
長度：300cm
(格柵裝飾條40100*2+鋁H40*1)



Edge cove/修飾邊框
CT40200

Range of application : Exterior Sunshade, Small Columns, Small Beams, Railing, etc
適用範圍：外遮陽、小柱、小樑、欄杆等..

Product Name : S60100

Dimension : 60mm * 100mm
Length : 300cm
WPC decorative articles 6050*2
Aluminum base S100*1
尺寸：60mm * 100mm
長度：300cm
(格柵裝飾條6050*2+鋁S100*1)



鋁基座
Aluminum base
S100

Product Name : M6050

Dimension : 60mm * 50mm
Length : 300cm
WPC decorative articles 6050*1
Aluminum base M605*1
尺寸：60mm * 50mm
長度：300cm
(格柵裝飾條6050*1+鋁M605*1)



鋁基座
Aluminum base
S100

NEW

Range of application : Exterior Wall Cladding
適用範圍：戶外牆板

Product Name : EWP-180U

Dimension :
width 203mm thickness 25mm
Length : 300cm
Effective width 189mm-Tiling/
175mm-Stacked
WPC decorative articles EWP180*1
Aluminum base 180U*1
尺寸：203mm * 25mm
長度：300cm
有效寬度：189mm-平面式
175mm-疊式
(格柵裝飾條EWP180*1+鋁180U*1)



鋁基座
Aluminum base
180U

鋁基座
Aluminum base
100W

Product Name : EWP-100W

Dimension : width 122mm thickness 16mm
Length : 300cm
Effective width 105mm
WPC decorative articles EWP100*1
Aluminum base 100W*1
尺寸：122mm * 16mm
長度：300cm
有效寬度：105mm
(格柵裝飾條EWP100*1+鋁100W*1)

Range of application : Exterior Decking, Exterior Wall Cladding
適用範圍：戶外地板、戶外牆板

Product Name : MT-181

Dimension : 181mm * 25mm
Length : 300cm
WPC decorative articles M181*1
Aluminum base 18T*1
尺寸：181mm * 25mm
長度：300cm
(格柵裝飾條M181*1+鋁18T*1)

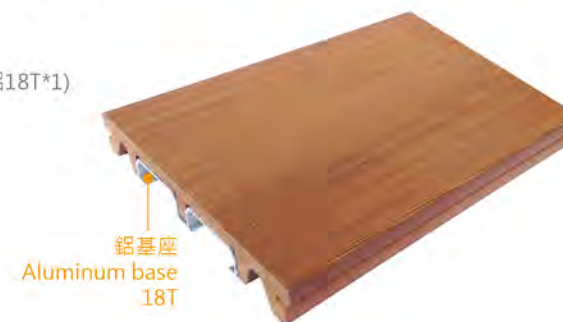

鋁基座
Aluminum base
18T

Range of application : Side Cover ,Angle Side Cover ,Decoration strip
適用範圍：收邊條、裝飾條

Product Name : L-5009

Dimension : 50mm * 59mm
Length : 300cm
WPC decorative articles 5009*2
Aluminum base L50*1
尺寸：50mm * 59mm
長度：300cm
(格柵裝飾條5009*2+鋁L50*1)

NEW



鋁基座
Aluminum base
L50

鋁基座
Aluminum base
150

Product Name : I-5009

Dimension : 50mm * 9mm
Length : 300cm
WPC decorative articles 5009*1
Aluminum base I50*1
尺寸：50mm * 9mm
長度：300cm
(格柵裝飾條5009*1+鋁I50*1)



鋁基座
Aluminum base
M80

NEW

Range of application : Chairs and Board Surface , Adumbral Louver, Grille etc
適用範圍：桌椅板面、遮陽百頁、格柵等...

Product Name : M8014

Dimension : width 80mm thickness 14mm
Length : 300cm
WPC decorative articles 8014*1
Aluminum base M80*1
尺寸：80mm * 14mm
長度：300cm
(格柵裝飾條8014*1+鋁M80*1)

1.Grille Series Ceiling, Facades shade, Blinds, Louvers door and window
格 柵 系 列 天 花、外 牆 遮 陽、百 頁、遮 陽 門 窗

Commonly used models 常用型號	M6040	S60100
	M12050	H6080
	M40100	S6080

- ◆ For Indoor installation, use small segment point installation
- ◆ For Outdoor installation, use full length installation
- ◆ Outdoor installation, if the span for the fixing points are large, adopt reinforcement throughout the full length installation
(Using aluminum rectangular tube... keel etc, strengthening in the structure; to overcome the large span)

- ◆ 室內安裝時，採用節點方式
- ◆ 室外安裝時，採用貫穿方式
- ◆ 室外安裝時，固定點跨距較大時，採用貫穿加強型安裝
(利用鋁方通.....等龍骨加強於中心位置；克服跨距的限制)。

Outdoor type throughout the installation - outdoor metope grille
貫穿型安裝 - 室外牆面格柵

Model / Aluminium base 型號 / 鋁基座	Dimensions (Width x Thickness) 尺 寸 (寬*厚)	Aluminium fixed base distance / cm 鋁基座固定距離 / c m		
		Horizontal Install 牆面 _ 橫向安裝	Vertical Install 牆面 _ 直向安裝	Ceiling Install 天花安裝
M6040/M60	60*40mm	100Cm	150Cm	150Cm
M40100/M40	40*100mm	100Cm	150Cm	150Cm
M12050/M120	120*50mm	150Cm	150Cm	150Cm
M12060/M120	120*60mm	150Cm	150Cm	150Cm
H6080/H60	60*80mm	150Cm	150Cm以上	****
S6080/S60	60*80mm	150Cm以上	150Cm以上	****
S60100/S100	60*100mm	150Cm以上	150Cm以上	****
M8014	80*14mm	100Cm	100Cm	****



Grille installation procedures and precautionary information :

1. Install the angle section on the wall (take note of alignment), the span varies according to the profile specifications.
*Types of angle section could be aluminum, wood, wood composite, C steel channel ... depending on site requirement.
*If the wall surface is relatively flat and could be nailed, the aluminum base could be directly fitted to the wall.
2. Align the full length aluminum base across the angle section and fixed at intersection points.
3. Using a mallet, tapped the fixture of the aluminum base and fitted it to the angle section.
4. Based on the site requirement, there are two ways in which the end side could be sealed :
a.Directly use plastic side cover to seal the end side. b.Using the wood composite and cut 45 degree joining to seal the end side.
- 5.Complete.

格柵安裝示意及注意事項:

- 1.將角材安裝於牆面上(注意水平)，距離依型材規格而異。
* 角材種類可為鋁材、實木、塑木、C型鋼....考量現場條件
* 牆面如果平整度夠，又可以打釘安裝時可以不需要安裝角 材，直接將鋁基座固定於牆面即可。
- 2.將鋁基座依格柵設計間距固定於與角材接觸點。
- 3.將塑木格柵利用橡膠錘輕敲，以達到與鋁基座密合。
- 4.視現場需求進行最後封邊。封邊方式有二種：
a.直接利用塑膠邊蓋進行封邊。b.利用原材質裁切45度角對接。
- 5.完成。



- Trimming / Ceiling Series
- Hollow cavity profiles reduce the thermal conductivity which in turn greatly reduce the energy transmission losses
 - Insulation and heat preservation enable energy saving
 - Texture and colour combination showcase the vitality of wood
 - Flexible design which allow creative unlimited possibilities
 - Weather resistance, non-toxic, lead free, formaldehyde free
 - Do not deteriorate, crack, brittle, chalk
 - Waterproof, flameproof with fire retardant properties



Construction Advantages

- ◆ The installation conceals the hardware accessories; thus beautifying and enhancing the visual effect of the installation.
- ◆ Ease of maintenance and allow individual section replacement.
(By using individual section installation, when there are localized damages, the repair and replacement works will be convenient and easy)
- ◆ As the spacing between the grids could be easily and freely modify, such installation methods are favorable when on site minor re-adjustment are required.
- ◆ Convenient to seal the end side.

格柵天花系列 施工優點

- ◆ 安裝完成隱藏五金配件，提升視覺美化效果。
- ◆ 維修便利性，單獨拆換。
(因採用單支安裝方式，局部損壞時，修繕拆裝非常容易)。
- ◆ 格柵間距，龍骨間距自由設計，皆能滿足現場需求。
- ◆ 封邊蓋安裝便利。

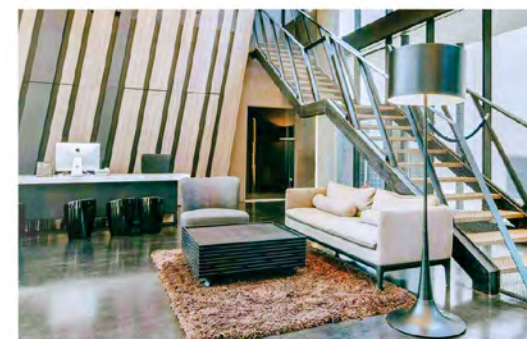
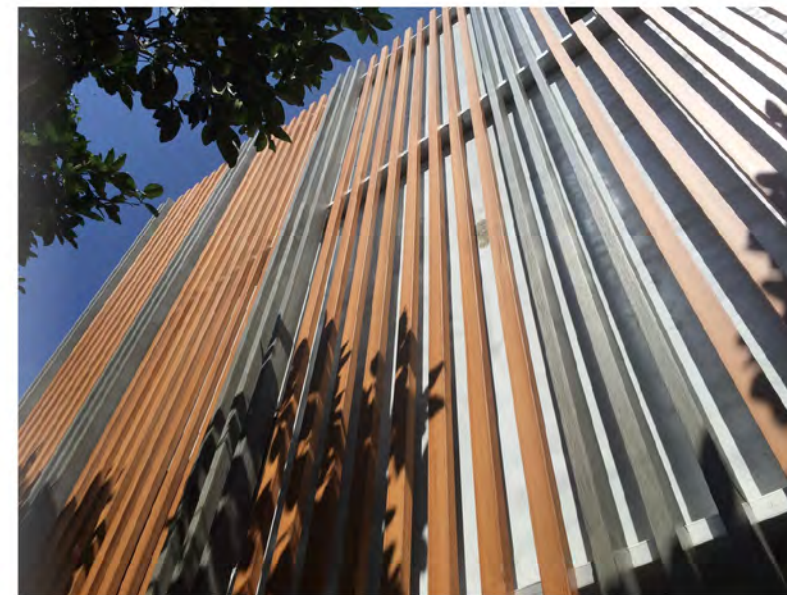
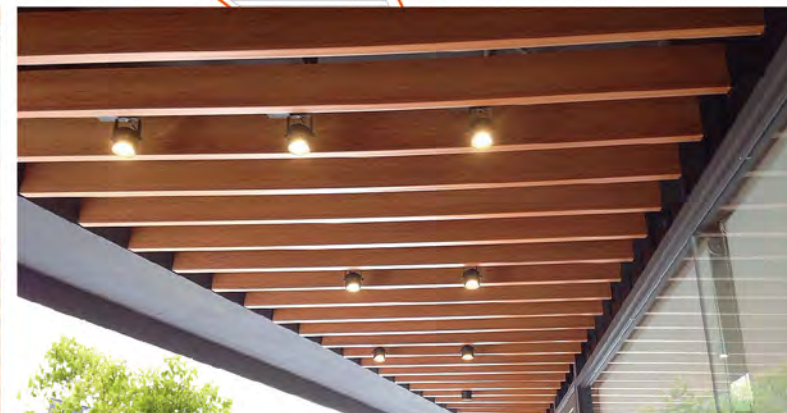
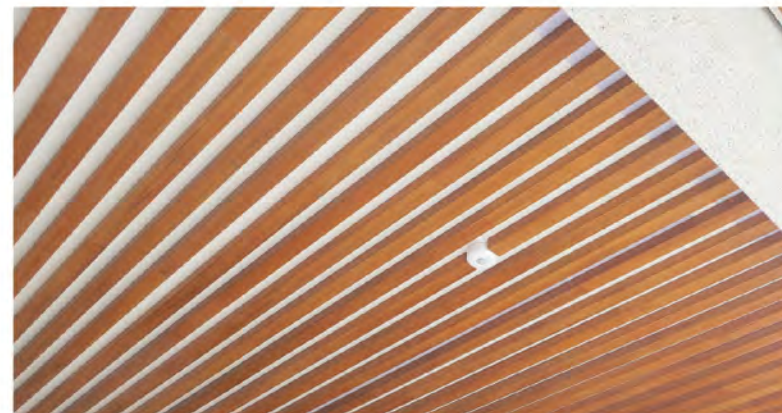

Pluralism

2. Wall Panel Series 牆板系列

Commonly used models
常用型號

M181 Multi-function panel M181多功能板
EWP-100W Exterior wall flat panel EWP-100W外牆平面板
EWP-180U Multi-function exterior wall panel EWP-180U多功能外牆板

M181 Multi-function panel 多功能板

Alucowood M181 wall cladding installation procedures and precautionary information :

1. When installing joist / keel, the spacing or span should be 100cm.
(Types of joist : wpc joist, timber joist, C channel steel joist etc, depending on requirement)
2. Care should be taken for flatness of the joist against the wall.
3. When docking the end of one wall cladding to the beginning of the next wall cladding, the ends converge should be closely fitted (with no gap).
4. Between the wall cladding, the sides are docked and secured with aluminum profile 18H.
5. Based on the site requirement, the edges could be covered.
To cover the edges, " trimming edge panel " could be nailed direct for securing.
(trimming edge panels : YFI-01, XTI-14... etc, depending on requirement)

Note: Depending on requirement, aluminum base profile (18T) for M181 wall cladding may not used for installation but the spacing or span of the joist must be $\leq 60\text{cm}$.

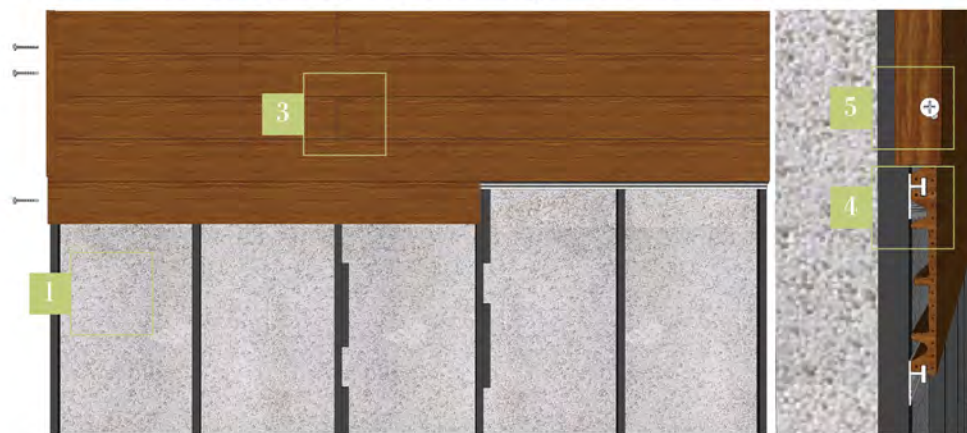

鋁新木M181牆板安裝示意及注意事項:

1. 安裝角材，角材間距100cm。
(角材種類:塑木角材、實木角材、C型鋼角材...等視現場需求。)
2. 需注意角材平整度。
3. 遇面板對接時，銜接處須密拼（不留縫）。
4. 面板間以專用鋁型材18H固定。
5. 視現場需求進行最後封邊。封邊可直接利用 " 封邊板材 " 打釘固定在側邊即可。
(封邊板材:YFI-01、XTI-14等...視實際需求)。

附註:面板M181下方的鋁基座(18T)視實際需求可免安裝,但角材間距需 $\leq 60\text{cm}$ 。



EWP-180U Multi-function exterior wall panel 多功能外牆板

1. When installing joist / keel, spacing span of less than 100cm.
(Types of joist : wpc joist, timber joist, C channel steel joist etc, depending on requirement)
2. Care should be taken for flatness of the joist against the wall.
3. When docking the end of one wall cladding to the beginning of the next wall cladding, the ends converge should be closely fitted (with no gap).
4. Between the wall cladding, Use wood screws with fixed latch.
5. Based on the site requirement, the edges could be covered.
To cover the edges, " trimming edge panel " could be nailed direct for securing.
(trimming edge panels : YFI-01, XTI-14... etc, depending on requirement)

1. 安裝角材，角材間距小於100cm。
(角材種類：塑木角材、實木角材、C型鋼角材...等視現場需求。)
2. 需注意角材平整度。
3. 遇面板對接時，銜接處須密拼（不留縫）。
4. 面板間以木螺絲釘配合卡榫固定。
5. 視現場需求進行最後封邊。封邊可直接利用 " 封邊板材 " 打釘固定在側邊即可。
(封邊板材:YFI-01、XTI-14等...視實際需求)。

EWP-180U Multi-function exterior wall panel schematic drawings
EWP-180U多功能外牆板示意圖



Stacked installation 疊式安裝

Flat installation 平面式安裝

EWP-100W Exterior wall flat panel 外牆平面板

1. When installing joist / keel, spacing span of less than 60cm.
(Types of joist : wpc joist, timber joist, C channel steel joist etc, depending on requirement)
2. Care should be taken for flatness of the joist against the wall.
3. When docking the end of one wall cladding to the beginning of the next wall cladding, the ends converge should be closely fitted (with no gap).
4. Between the wall cladding, Use wood screws with fixed latch.
5. Based on the site requirement, the edges could be covered.
To cover the edges, " trimming edge panel " could be nailed direct for securing.
(trimming edge panels : YFI-01, XTI-14... etc, depending on requirement)

1. 安裝角材，角材間距小於60cm。
(角材種類：塑木角材、實木角材、C型鋼角材...等視現場需求。)
2. 需注意角材平整度。
3. 遇面板對接時，銜接處須密拼（不留縫）。
4. 面板間以木螺絲釘配合卡榫固定。
5. 視現場需求進行最後封邊。封邊可直接利用 " 封邊板材 " 打釘固定在側邊即可。
(封邊板材:YFI-01、XTI-14等...視實際需求)。

EWP-100W Exterior wall flat panel schematic drawings
EWP-100W外牆平面板示意圖



3.Decking Series 地板系列

Commonly used models
常用型號 M181 Multi-function panel MT181多功能板

MT181Multi-function panel 多功能板

Alucowood MT181 decking installation procedures and precautionary information :

1. When installing joist / keel, the spacing or span should be 40cm.
(Types of joist : wpc joist, timber joist, C channel steel joist etc, depending on requirement)
2. Care should be taken for leveling and water discharge slope leveling for the joist.
3. During installation of decking, the first roll and the last roll of the decking should be nailed direct from the top and secure to the bottom joist.
4. When docking the end of one decking to the beginning of the next decking, the ends converge should be closely fitted (with no gap) and the width of the joist directly supporting below the ends converge should be not less than 4cm. If the width of the joist use directly supporting below the ends converge is only 2.5cm, additional piece of joist must be added to make the width 5cm.
5. Between the decking, the sides are docked and secured with fasteners, and bring about a 5mm gap for water discharge.
6. Based on the site requirement, the edges could be covered.
To cover the edges, " trimming edge panel " could be nailed direct for securing.
(trimming edge panels : YFI-01, XTI-14, DBO0613-PSU... etc, depending on requirement)

鋁新木MT181地板安裝示意及注意事項:

1. 安裝角材・角材間距40cm。
(角材種類:塑木角材、實木角材、C型鋼角材...等視現場需求。)
2. 需注意角材水平與洩水坡度。
3. 安裝面板時，第一片與最後一片面板正面下釘固定於角材上。
4. 遇面板對接時，銜接處須密拼（不留縫）且角材面寬不得低於4cm。
5. 面板間以專用扣件固定，以產生5~6mm洩水縫。
6. 視現場需求進行最後封邊。封邊可直接利用 " 封邊板材 " 打釘固定在側邊即可。
(封邊板材:YFI-01、XTI-14、DBO0613等...視實際需求)。

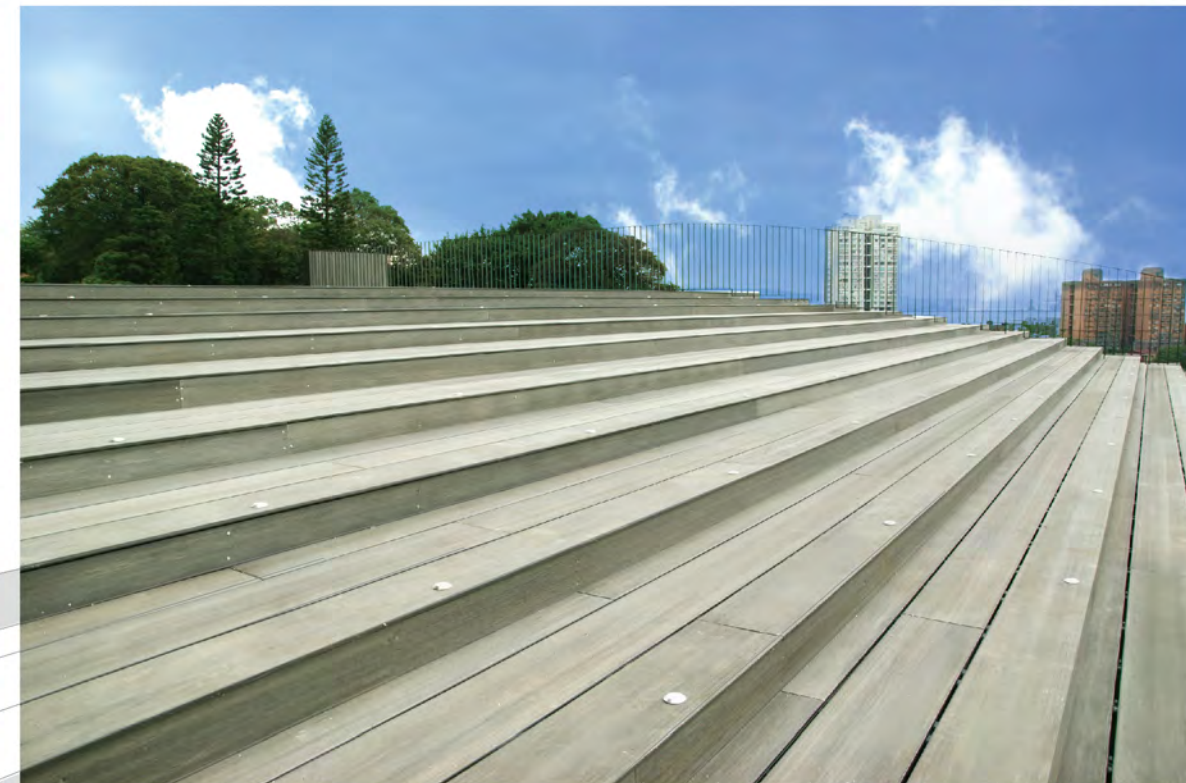
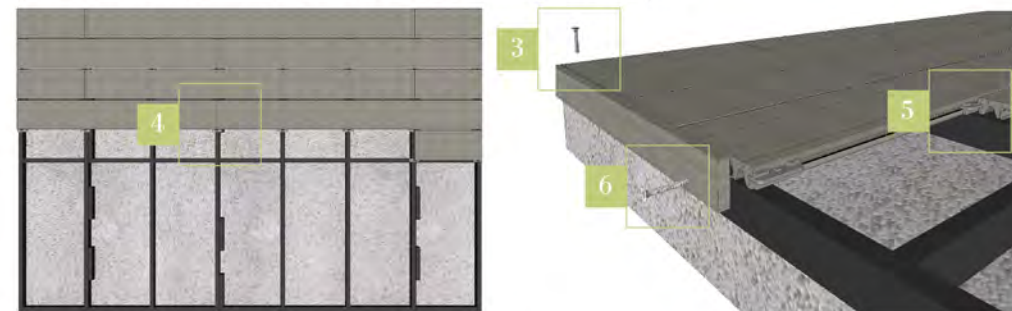

4.Railing Series 欄杆系列

Commonly used models
常用型號

S(T)120120
S60100
S6080



Balustrade Series

Unique resemble to the appearance and aesthetics of natural wood, with unlimited creative application
Weather resistance, UV absorption, radiate and reflect sunlight to reduce discomfort
Non-toxic, lead free, formaldehyde free
Do not deteriorate, crack, brittle, chalk
Water resistance, flameproof with flame retardant properties

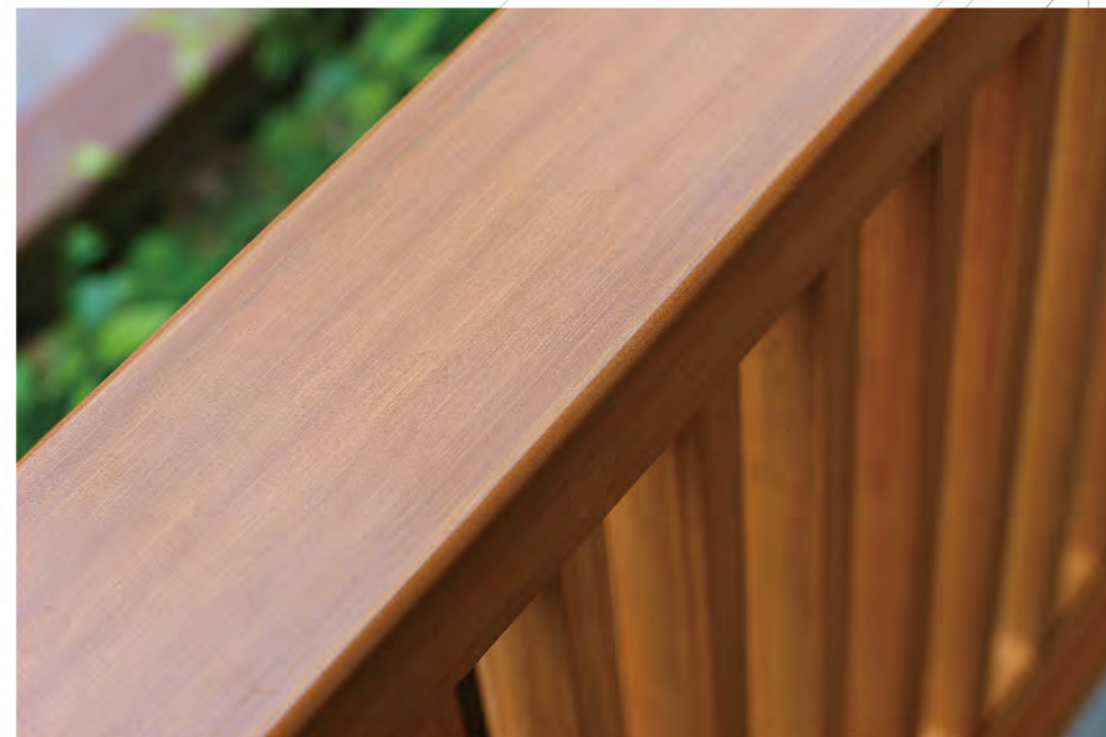

欄杆系列

獨有的木質美感與觸感，讓空間創意無限
耐侯性佳，吸收紫外線和輻射線，降低陽光反射的不適感
無毒、無鉛、無甲醛
不變質、不開裂、不脆化、不粉化
防水、防焰、阻燃效果佳

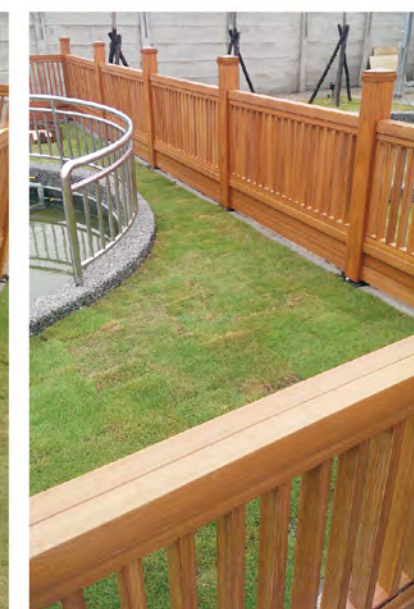

5.Trellis Series 花架系列

Commonly used models
常用型號

(Large大)10x10(ft呎)
(Medium中) 8x 8(ft呎)
(mall小S) 6x 6(ft呎)

Column specification立柱規格

S(T)120120
S(T)120120
S60100

Beam specification橫樑規格

S120100
S60100
M40100

Wisdom Of Building Space

Wide usage in building space, brilliant and creative combination for detail and ingenuity
The design of using hollow cavity profiles reduce the thermal conductivity which in turn greatly reduce the energy transmission losses



建築空間的智慧

建築空間的智慧，在於每一細節與巧思相互結合、
衝擊後所創造出的火花，中空多腔結構的設計運用，
降低熱傳導率減少能源傳散損失以達到節能目的。

6.Kiosk, Gazebo, Pergola Series / Glass curtain / Conservatory 凉亭廊架系列 / 玻璃帷幕 / 阳光房

Commonly used models
常用型號
S(T)120120 S120100
S60100 S6080
Roof panel屋頂板: EWP-100W



Infinite Possibilities for Building Application

Unique resemble to the appearance aesthetics
colour and texture of natural wood .
The materials blend well with the design
application creating unlimited possibilities!

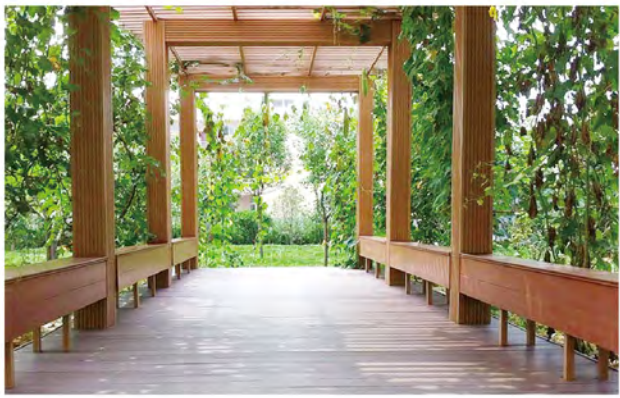

建築空間的無限可能
獨有的木質美感,細緻紋路與色澤質感的交叉運用
設計與材質的契合,造就空間無限可能!

7.Comprehensive Application 綜合應用

Outdoor Furniture 戶外家具



Main Door, Gate / Grille door / Electric sliding door

戶外大門 / 格柵門 / 電動滑門



Staircase Step Panel

樓梯踏板



Planter boxes, Signage

花箱 / 指示牌

Lamppost

燈柱



Trash bin

垃圾桶



鋁新木[®]

AluCo-Wood

WOODEASY International Co.,LTD

🏠 No.93-9, Zhongshan 8th Rd., Daya Dist.,
Taichung City 428, Taiwan (R.O.C.)

🌐 <http://www.woodeasy.com.tw>

✉ alucowood@gmail.com

📞 +886-4-2567-7397

📠 +886-4-2560-0174

杉澤國際有限公司
42841台中市大雅區中山八路93-9號

f 杉澤國際有限公司WOODEASY 🔍

